

groov▶▶e

GV-MA211 Mini Printer



User Manual

Portable Wireless
Thermal Printer

 **Bluetooth®**
groov-e.co.uk



30 Day Right To Return

We do not envisage any problems occurring with your groov-e GV-MA211 Mini Printer, Portable Wireless Thermal Printer. However, for your peace of mind, should any fault occur, please return it within 30 days to your retailer with proof of purchase for an exchange or refund.



12 Month Guarantee

This product is guaranteed for twelve months. Please retain your receipt as this will be required as proof of purchase in the event that the device does not perform as expected then please contact your original point of purchase, should you require further assistance then please contact us.



Extended Warranty

Please register your product within 30 days from date of purchase www.groov-e.co.uk/warranty. Proof of purchase required.



Contact Us

Reach out to us at info@groov-e.co.uk or visit www.groov-e.co.uk

“Congratulations on your purchase and **Thank You** for choosing the groov-e GV-MA211 Mini Printer, Portable Wireless Thermal Printer. Please read the user guide carefully before using”.



Important safety information

- *Keep the product and all its parts out of reach of children under 3 years of age.*
 - *Only use the USB cable that came with the product. Using an unauthorised cable will invalidate your guarantee and may irrecoverably damage the product.*
 - *This product has an integral rechargeable battery and should not be disposed of in the normal household waste but taken to an appropriate recycling facility, where and when these are available*
 - *Never throw batteries in a fire or attempt to open the outer casing.*
 - *This product does not contain any user serviceable parts.*
- Unauthorised handling of the device may damage it and will void your warranty.*
- *Keep it dry. Avoid exposure to precipitation, humidity and liquids which could all affect the product circuitry.*
 - *Do not leave it in low temperatures as moisture can form inside the product, which may damage the circuit board.*
 - *Do not leave it in high temperatures as electronic devices and plastic parts may warp in heat.*
 - *Keep it away from bright sunlight or heat sources, such as a radiator.*
 - *Never place any type of candle or naked flame on top of, or near the product.*
 - *Do not touch the Thermal Printer head to avoid scalding and prevent the printer from overheating.*
 - *Be careful not to touch the the paper tear blade as it is sharp any may cause injury.*



Caution: Danger of explosion if batteries are incorrectly replaced

In the box:

1 x GV-MA211

1x USB-C Charging cable

1 x Thermal Paper Roll 57x25mm

2 x Self-adhesive Roll 57x25mm

1 x User Manual

FRONT



SIDE

**USB-C
Input**

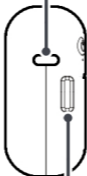

**Paper Compartment
Latch
(both sides)**

BACK

**Power
Button**

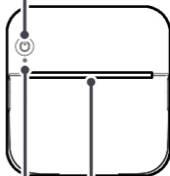

**LED
Indicator**
**Print
Output**

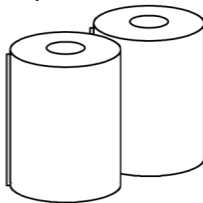
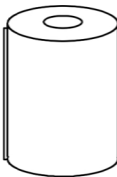

OPERATION

Charge the integral Printer battery

Your printer has an integral 3.7V, 1200 mAh rechargeable battery. Before you use your printer for the first time, we recommend that you fully charge the battery, which will take approximately 2 hours.

1. Connect the USB-C end of the charging cable into the USB-C socket on the side of the printer. Plug the USB-A end of the charging cable into a computer or other USB charging device. You can use a mains power charger with an output voltage of 5V/1A but please **Do NOT** use a mains power charger above 5V or fast charging as this may damage the printer.

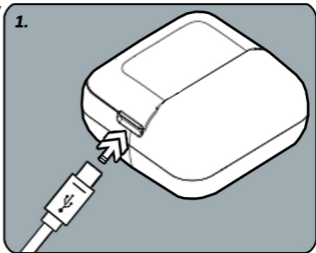

The red battery charging LED on the back of the printer, underneath the power button, will turn red and the integral battery will begin to charge.

When the battery is fully charged the red charging LED on the back of the printer will turn off. From a full charge, you will be able to use your printer continuously for approximately 4-5 hours (up to 2 hours with continuous printing).

Turning On/Off

- 1.** Long press the Power Button for 3 seconds to turn on the printer.
- 2.** Long press the Power Button again for 3 seconds to turn the printer off.

Downloading the Fun Print App

1. Using your smart device scan the QR code to download the Fun Print app. You can also use the Apple Store or Google Play Store to download the Fun Print app. Once downloaded follow the in-app instructions.



OPERATION

Connecting to Bluetooth

Turn on the Bluetooth function on your smart device and search for available devices. The printer will show in the list as "GV-MA211" select this to connect the printer to your smart device. You can now use the app to print from your smart device.



Using the App

Fun Print is the smart app for your printer. You can print your memorable moments on post-it sized stickers.

Send your moments to your loved and event print banners.

Fun Print Application feature

- Print memos, text & labels
- Take photo and print images

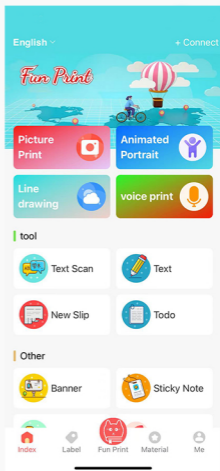

OPERATION

LED Indicator

The LED Status Indicator is located under the Power Button.

Flashing Green Light: The printer is waiting for a Bluetooth Connection.

Solid Green Light: Bluetooth has successfully connected.

Solid Red Light: The printer is Charging.

Changing the Printing or Sticker Paper

When the APP prompts you to run out of printer paper, please refill the printer paper.

With the Printer turned off:

1. With the back of the printer facing you, hold the printer steady and then press the paper compartment release buttons on the sides of the printer inwards and up at the same time. Open the paper compartment lid and remove any printing or sticker paper from the previous roll that may still be inside the compartment.

2. Drop the new Printing or Sticker paper roll into the compartment with the loose end at the top so that the paper will unroll from the top. This is an important step as your Camera will not be able to print if the paper is not the right way up.

3. Unstick the new roll and pull a 2cm section of the paper out so that when you shut the printing paper compartment lid, it will feed freely through the printing paper slot. You are now ready to print your photos again.

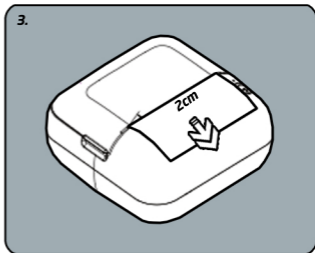
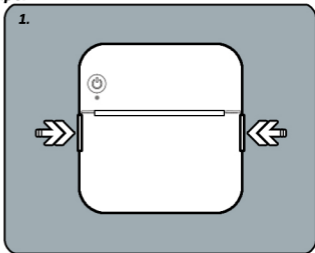

Note: When you need replacement printing or sticker paper, you should buy 57mm x 25mm thermal printer paper rolls or sticker paper to fit your printer.

FEATURES

- Bluetooth connectivity
- 200DPI print resolution
- Thermal printer (no ink required)
- Black & White print
- Easy to use multifunctional "Fun Print" APP
- Compatible with iOS & Android smartphones
- OCR text recognition/Note/Image/Memo/List/Text/Labels/Web/QR code printing
- 3.7V, 1200mAh Rechargeable battery
- Battery fully charged usage time: 4-5 hours (up to 2 hours for continuous printing)
- Battery charging time around 2hr
- Pocket printer size (80x80x35mm)
- Type-C USB cable (included)
- **1 x** thermal paper roll 57x25mm (included)
- **2 x** self-adhesive roll 57x25mm (included)
- Charging input: DC 5V/1A



Thermal Rolls
Included



Bluetooth
Connectivity



Smartphone
Compatible

TROUBLESHOOTING

The Printer does not work or is very faint

- You may need a new Printer Paper roll or the Printer Paper may not be installed correctly. Please check the printer paper compartment. Please refer to the 'Changing the Printer or Sticker Paper' section'.
- Allow the Printer time to warm up before using the Printer.

Note: The Printer cannot be used while it is charging.

BATTERY DISPOSAL

This product contains batteries and should not be treated as normal household waste and should be recycled. Please take it to your nearest collection facility or for further details contact your local council or visit www.recycle-more.co.uk

Batteries contain substances that may be harmful to the environment and human health. Keep out of the reach of children and seek immediate medical help if swallowed.

Never throw batteries into a fire or attempt to open the outer casing.

Should your product develop a fault please visit our website at www.groov-e.co.uk

Environment Protection

Waste electrical products should not be disposed of with household waste.

Please recycle where facilities exist.

Check with your Local Authority or retailer for recycling advice.



GUARANTEE

Subject to the conditions stated below, Groov-e guarantees this equipment against defects in workmanship or materials of its mechanical and electronic component parts (excluding styling, battery cells, magnetic tapes, re-chargeable batteries, user removable memory devices, with the exception where the battery is inbuilt into the product) for a period of one year from the date of purchase. This product will be repaired or if necessary replaced free of charge if it has been proven to be defective within the one year warranty period.

- 1) Claims under this guarantee should be made through the authorised dealer/retailer from whom the equipment was purchased. If this is not possible, please contact Groov-e directly.**
- 2) This guarantee is only valid when the equipment is purchased and retained within the United Kingdom and a valid proof of purchase has been provided.**
- 3) This Guarantee Excludes:**
 - (i) All damage caused through accident, misuse, wear and tear, neglect, installation and/or use in a manner inconsistent with technical and safety standards.**
 - (ii) Alterations or adjustments made to equipment**
 - (iii) Loss of data resultant from malfunction of hard drive or other storage device**
 - (iv) Damage caused to any third party device as a result of using the product.**
- 4) No liability under this guarantee shall be incurred:**
 - (i) In respect of damage or loss occurring during transit to or from the purchaser**
 - (ii) Where the serial number plate of the equipment has been removed or altered in any way.**
- 5) Groov-e shall not be liable for consequential damage, loss or injury arising from or in connection with the equipment, excepting only that nothing in this condition shall or shall be construed so as to exclude or restrict liability for negligence.**
- 6) The cost of carriage to and from Groov-e shall be borne by the purchaser.**
- 7) This guarantee is personal to the original purchaser and is not transferable**
- 8) If the equipment, in respect of which a claim hereunder is made, is found on examination to comply with the published specifications, a test fee may be incurred.**

This guarantee is in addition to and does not in any way affect any statutory or other right of consumer purchasers, including those rights in relation to sections 13 to 15 of the Sale of Goods Act 1979, the Sale and Supply of Goods to Consumer Regulations 2002, The Consumer Rights Act 2015 or the Sale of Goods and Supply of Services Act 1980 (for ROI).

DECLARATION OF CONFORMANCE

Groov-e hereby declares that this product is in compliance with the essential requirements and other relevant provisions of the Radio Equipment Directive 2014/53/EU. The complete declaration of conformity can be requested from us at:

groov»e

**Unit J
Braintree Industrial Estate
Braintree Road
Ruislip
Middlesex
HA4 0EJ UK**

www.groov-e.co.uk

Email: info@groov-e.co.uk

Telephone: 020 8839 0978

Register your purchase for extended warranty

www.groov-e.co.uk/warranty

Authorised EU Representative

*Rashmian EU Ltd
Robwyn House
Suite 3E
Corrintra
Castleblayney
Co. Monaghan
Ireland*

To access our Product Support and Troubleshooting Information (PSTI) policy, please scan the QR code provided below.

